

Order #: 70574
216076-Rons Hauler

Status: Version: Created: Revised:
Scheduled 40.51.2 7/20/2018 10/2/2018



SALES CONTACT:

HITCHES

CONTACT INFORMATION

NOTES

No sales Tax is required to be collected by us if titled in Minnesota

MODEL INFO

Configured Model #: QSTAB8534+0-3A8.0K
 Quest Aluminum Trailer
 8.5'W x 34'L x 11.0'H, (3) 8000# Air Ride Axle(s)
VIN: 5JX1A3433KD216076
Warranty: 5 YR STR, 3 YR LTD, 1 YR ELEC WARRANTY

COLOR: BLACK
COLOR REAR: NONE
COLOR - CABINETS: POLAR WHITE

SPECIFICATIONS

Part Name	Qty	UOM	Total Ext. \$	Ref.
BASE MODEL				
QSTAB8534+0-3T8.0K	1	ea	\$29,387	STD
AXLE SPACING - SPREAD AXLE	1	ea		STD
ALL TUBE CONSTRUCTION	34	ft		STD
CROSS MEMBERS - FLOOR - 16" O/C	34	ft		STD
FRAME - 8"	34	ft		STD
FRAME - FULL PERIMETER - ALUMINUM	34	ft		STD
• VISIBLE AREAS: GLOSSY BLACK				
FRAME PROTECTION - SKID PLATES	1	pr		STD
FRONT DESIGN - FLAT	1	ea		STD
TRUCK PLUG - 7 WAY - BUMPER PULL	1	ea		STD
EXTERIOR ALUMINUM - STANDARD COLOR	34	ft		STD
• COLOR: BLACK				
EXTERIOR CAULK - PAINTABLE	1	ea	\$90	OPT
EXTERIOR FASTENER - SCREWLESS	34	ft		STD
FENDERETTES - AL - POLISHED	6	ea		STD
• POWDERCOATED: GLOSSY BLACK				
ROOF - ONE PIECE - ALUMINUM	34	ft		STD
DOT TAPE	34	ft		STD

LIGHT - CLEARANCE - LED - 12V - AMBER - LOWER	4 ea	STD
LIGHT - CLEARANCE - LED - 12V - AMBER - UPPER	4 ea	STD
LIGHT - CLEARANCE - LED - 12V - RED - LOWER	2 ea	STD
LIGHT - CLEARANCE - LED - 12V - RED - UPPER	7 ea	STD
LIGHT - TAILLIGHT - SLIMLINE - LED - 12V - RED	1 pr	STD
SWITCH - WALL - 12V	1 ea	\$35 PKG
<ul style="list-style-type: none"> REQUIRED BY: Puck Lights Under Upper Cabinet 		

PACKAGES

PACKAGE - STACKER	1 ea	(\$1,491) OPT
<ul style="list-style-type: none"> MODIFICATION: NO BEAVERTAIL 		
BATTERY BOX - IN-FLOOR - HOLDS UP TO 3 BATTERIES	1 ea	\$515 PKG
COUPLER - FLAT NOSE - 2-5/16" - 25,000#	1 ea	\$266 PKG
COVE MOLDING - H.D. STACKER	1 ea	PKG
CROSS MEMBERS - ROOF - 16" O/C - 1" X 2"	34 ft	PKG
DOOR - REAR RAMP - HD PREMIUM - CONTINUOUS ALUMINUM HINGE - 3600# RATED MAX LOAD - 6000# VEHICLE LOAD	1 ea	\$1,466 PKG
<ul style="list-style-type: none"> POWDERCOATED TRIM: GLOSSY BLACK 		
DOOR OPENING HEIGHT - REAR - 102"	1 ea	\$250 OPT
<ul style="list-style-type: none"> WITH: MAX CAPACITY 4000# DISTRIBUTED LOAD INCLUDES: UPGRADED SPRING ASSIST 		
RAMP DOOR EXTERIOR - REAR - COLOR MATCHED	1 ea	PKG
RAMP DOOR FLOORING - REAR - ALUMINUM - EXTRUDED	1 ea	\$1,054 OPT
DOOR LATCH - PADDLE - STAINLESS STEEL	1 pr	\$325 OPT
<ul style="list-style-type: none"> POWDERCOATED: GLOSSY BLACK 		
DOOR HARDWARE - BUMPER - ADJUSTABLE - ALUMINUM - SET OF 4	1 set	\$544 PKG
STRAP LIFT MECHANISM - 1 STRAP	1 ea	\$1,586 OPT
<ul style="list-style-type: none"> (1) 5000# D-RING INTERIOR MANUAL SWITCH WIRELESS REMOTE BATTERY REQUIRED FOR OPERATION - NOT INCLUDED 		
EXTERIOR FASTENER - SCREWLESS	34 ft	STD
EXTERIOR ALUMINUM THICKNESS - .050	34 ft	\$2,584 PKG
FRAME - 8"	34 ft	STD
GRAVEL GUARD - ATP - 48" - WITH J RAIL	1 ea	\$261 PKG
<ul style="list-style-type: none"> POWDERCOATED: GLOSSY BLACK 		
INTERIOR HEIGHT - 11.0'	34 ft	\$5,508 PKG
INTERIOR CEILING - SCREWLESS ALUMINUM	34 ft	\$748 PKG
<ul style="list-style-type: none"> COVE COLOR: POLAR WHITE CEILING COLOR: POLAR WHITE (STANDARD) SPRING BOX COLOR: POLAR WHITE 		
INTERIOR WALLS - SCREWLESS ALUMINUM	34 ft	\$2,006 PKG
<ul style="list-style-type: none"> WALL COLOR: POLAR WHITE (STANDARD) 		
INTERIOR WALLS - BEDRUG - 40" HIGH	34 ft	\$1,054 OPT
JACK - STABILIZER - POD - 3000#	1 pr	\$238 PKG
<ul style="list-style-type: none"> LOCATION: REAR 		
REMOTE - CORDED - FOR STACKER LIFT - (2) WALL PLUG-IN LOCATIONS	1 ea	PKG
TRIM - VERTICALS - FRONT & TOP RADIUS - COLOR MATCHED W/ CAST CORNERS - GLOSSY BLACK	1 ea	\$250 PKG
TRIM - RUB RAIL - LOWER - ALUMINUM - 7"	34 ft	\$340 PKG
<ul style="list-style-type: none"> POWDERCOATED: GLOSSY BLACK 		
TRIM - RUB RAIL - UPPER - ALUMINUM - 4"	34 ft	\$204 PKG
<ul style="list-style-type: none"> POWDERCOATED: GLOSSY BLACK 		

PACKAGE - ELECTRICAL #3	1 ea	OPT
BREAKER BOX - 50 AMP - 120V ONLY - 60 AMP CONVERTER - 12V FUSE PANEL - INTELI-POWER UNIT	1 ea	\$831 PKG
POWER INLET - MOTORBASE - 50A - W/ SHORE CORD - 25'	1 ea	PKG
• MOTORBASE COLOR: GLOSSY BLACK		
BATTERY - 12V AGM (930 CA, 775 CCA)	2 ea	\$522 PKG
• USED FOR: STACKER		
SWITCH - POWER CUT-OFF - MANUAL - 12V	1 ea	\$101 PKG
LIGHT - RECTANGULAR - LED - 18" - 12V - RECESSED - W/ TRIM RING	14 ea	\$2,100 PKG
SWITCH - WALL - 3 WAY - 12V	2 pr	\$180 OPT
• USED FOR: LIGHT - RECTANGULAR - LED - 18" - 12V - RECESSED - W/ TRIM RING		
SWITCH - RELAY - 12V - 30A	3 ea	\$120 OPT
• (3) RELAY SWITCHES REQUIRED WHEN OPTIONING MORE THAN (12) - 18" LED LIGHTS		
RECEPT - INTERIOR - 120V - 15A	8 ea	\$408 PKG
• GFCI PROTECTED WHERE REQUIRED BY CODE		
RECEPT - EXTERIOR - 120V - 15A - GFI PROTECTED - BLACK	4 ea	\$264 PKG
LIGHT - SCENE - LED - HIGH OUTPUT - 12V - NON RECESSED - 7" X 3" - BLACK BEZEL	4 ea	\$1,104 PKG
SWITCH - WALL - 12V	2 ea	\$70 PKG
• USED FOR: Exterior Scene Lights		

PACKAGE - GLOSSY BLACK TRIM	1 ea	\$3,672 OPT
• EXTERIOR SKIN IS OPTIONED SEPARATELY		

OPTIONS

CROSS MEMBERS - WALL - CS - 16" O/C - 2" X 2"	34 ft	\$1,802 OPT
CROSS MEMBERS - WALL - RS - 16" O/C - 2" X 2"	34 ft	\$1,802 OPT
FLOOR DESIGN - FLAT	1 ea	OPT
FRAME PROTECTION - BOGEY WHEELS	1 pr	\$305 OPT
TANK - FUEL - DIESEL - 24 GALLON - END FILL - IN FRAME	1 ea	\$2,143 OPT
FUEL FILLING STATION - GAS - 24 GALLON TANK	1 ea	\$2,281 OPT
• INCLUDES PUMP, HOSE & NOZZLE		
• TANK FITTINGS		
• 12V SWITCH FOR FUEL PUMP		
• LOCATION: ROAD SIDE		
JACK - TONGUE - HYDRAULIC - SINGLE POST	1 ea	\$1,969 OPT
TIRE/WHEEL - 215/75R17.5/LRH - RADIAL ON ALUMINUM - GOODYEAR	6 ea	\$3,300 OPT
POWDER COAT WHEEL - GLOSSY BLACK	6 ea	\$1,008 OPT
SPARE TIRE COMPARTMENT - IN FLOOR	2 ea	\$1,060 OPT
TONGUE - EXTENDED TRIPLE TUBE - 12"	1 ea	\$197 OPT
• PAINTED: GLOSSY BLACK		
SKIRTING - PERIMETER SKIRTING W/ REVERSE BEAVERTAIL	1 ea	\$1,064 OPT
• INCLUDES: CUSTOM WHEELWELL SKIRT, FULL PERIMETER SKIRTING, SINGLE FENDERETTE OVER EACH WHEEL		
VENT - ROOF - 12V FANTASTIC FAN	3 ea	\$1,464 OPT
• RAIN SENSOR		
• REVERSIBLE FAN		
• WALL MOUNT THERMOSTAT		
• BATTERY NOT INCLUDED		
VENT - ROOF - 12V FANTASTIC FAN	1 ea	\$488 OPT
• RAIN SENSOR		
• REVERSIBLE FAN		
• WALL MOUNT THERMOSTAT		
• BATTERY NOT INCLUDED		
VENT SYSTEM - TWO WAY - SALEM	1 pr	\$197 OPT

- POWDERCOATED: GLOSSY BLACK

DOOR - ENTRANCE - 405 SERIES - 48" X 72" - FMVSS LOCK	1 ea	\$542 OPT
<ul style="list-style-type: none"> • RIGHT HINGE • POWDERCOATED TRIM: GLOSSY BLACK 		
GAS SHOCK ON ENTRANCE DOOR	1 ea	\$131 OPT
STEP - SLIDE IN/OUT - ALUMINUM - 48"	1 ea	\$391 OPT
DOOR - ENTRANCE - 405 SERIES - 48" X 72" - FMVSS LOCK	1 ea	\$1,381 OPT
<ul style="list-style-type: none"> • LEFT HINGE • POWDERCOATED TRIM: GLOSSY BLACK 		
GAS SHOCK ON ENTRANCE DOOR	1 ea	\$131 OPT
STEP - SLIDE IN/OUT - ALUMINUM - 48"	1 ea	\$391 OPT
DOOR - FUEL - CAST ALUMINUM - LOCKABLE	1 ea	OPT
<ul style="list-style-type: none"> • POWDERCOATED: GLOSSY BLACK 		
DOOR - FUEL - 405 SERIES - 20" X 20"	2 ea	\$262 OPT
<ul style="list-style-type: none"> • LEFT HINGE • POWDERCOATED TRIM: GLOSSY BLACK 		
DOOR - FUEL - 405 SERIES - 10" X 10"	2 ea	\$194 OPT
<ul style="list-style-type: none"> • LEFT HINGE • POWDERCOATED TRIM: GLOSSY BLACK 		
CABINET - ALUMINUM - LOWER - STRAIGHT - 72"W	1 ea	\$791 OPT
<ul style="list-style-type: none"> • CABINET COLOR: POLAR WHITE 		
COUNTERTOP - ALUMINUM - FOR LOWER CABINET	6 ft	OPT
<ul style="list-style-type: none"> • USED FOR: 72" STRAIGHT CABINET 		
CABINET - ALUMINUM - 24"W 5-DRAWER INSERT	1 ea	\$1,569 OPT
CABINET - ALUMINUM - UPPER - STRAIGHT - 72"W - W/ RADIUS LOWER EDGE - TOP HINGED DOORS AND GAS SHOCKS	1 ea	\$862 OPT
<ul style="list-style-type: none"> • CABINET COLOR: POLAR WHITE 		
INSULATION - CEILING - CLOSED CELL - 1" - R-6.5	34 ft	\$1,054 OPT
INSULATION - WALLS - CLOSED CELL - 1" - R-6.5	34 ft	\$2,584 OPT
<ul style="list-style-type: none"> • BUBBLE FOIL INSULATION INSTALLED ALONG WIRING RUNS • NOT RECOMMENDED FOR COLD TEMPERATURES 		
FLOORING - ALUMINUM - EXTRUDED	34 ft	\$3,536 OPT
LADDER - INTERIOR - BOLTED TO FRAME	1 ea	\$501 OPT
AIRLINE TRACK - RECESSED - FLOOR	117 ft	\$2,925 OPT
BATTERY - 12V AGM (930 CA, 775 CCA)	1 ea	\$261 OPT
<ul style="list-style-type: none"> • ISOLATED TO GENERATOR ONLY 		
BATTERY - 12V AGM (930 CA, 775 CCA)	1 ea	\$261 OPT
LIGHT - CLEARANCE - LED - 12V - AMBER - LOWER	6 ea	\$126 OPT
LIGHT - CLEARANCE - LED - 12V - AMBER - UPPER	6 ea	\$126 OPT
LIGHT - DOCKING - LED - STAINLESS STEEL - 12V	1 pr	\$325 OPT
LIGHT - ANGLED PORCH - LED - 12V	1 ea	\$108 OPT
SWITCH - WALL - 12V	1 ea	\$35 OPT
<ul style="list-style-type: none"> • USED FOR: LIGHT - ANGLED PORCH - LED - 12V 		
RECEPT - INTERIOR - 120V - 15A - USB - BLACK	2 ea	\$320 OPT
<ul style="list-style-type: none"> • GFCI PROTECTED WHERE REQUIRED BY CODE • INCLUDES: 2 USB CHARGING PORTS 		
LIGHT - PUCK - LED - 2.75" - 12V - NON RECESSED	5 ea	\$255 OPT
<ul style="list-style-type: none"> • Location: Under Upper Cabinet 		
LIGHT - RECTANGULAR - LED - 18" - 12V - RECESSED - W/ TRIM RING	7 ea	\$1,050 OPT

SWITCH - WALL - 12V • USED FOR: LIGHT - RECTANGULAR - LED - 18" - 12V - RECESSED - W/ TRIM RING	1 ea	\$35 OPT
SWITCH - RELAY - 12V - 30A • (2) RELAY SWITCHES REQUIRED WHEN OPTIONING MORE THAN (6) - 18" LED LIGHTS	2 ea	\$80 OPT
SWITCH - WALL - 12V	1 ea	\$35 OPT
SWITCH - WALL - 12V • USED FOR: LED LIGHTS IN REAR SPOILER	1 ea	\$35 OPT
GENERATOR - COMMERCIAL - 8.0 KW ONAN - DIESEL - (120V ONLY)	1 ea	\$12,565 OPT
REMOTE START	1 ea	PKG
FUEL GAUGE	1 ea	OPT
TRANSFER SWITCH - AUTO - 50A	1 ea	OPT
SOLAR PANEL - 50W - ROOF MOUNTED • CHARGE CONTROLLER INCLUDED	1 ea	\$835 OPT
WINCH BOX - IN FLOOR	1 ea	\$452 OPT
WINCH - 4500# - W/ 50' SYNTHETIC ROPE & 10' CORDED REMOTE • 4500# ROLLING WEIGHT	1 ea	\$1,075 OPT
ALARM SYSTEM - PRO TEC PREMIUM W/ CELLULAR NOTIFICATION - USA • CELLULAR SUBSCRIPTION AND ACTIVATION REQUIRED • ALARM SOUNDS - LIGHTS FLASH - BRAKES LOCK • (2) KEY FOB REMOTES INCLUDED • (3) DOOR SENSORS INCLUDED • INSURANCE REBATE CARD • LIFETIME WARRANTY • NO ANTENNA REQUIRED • END USER RESPONSIBLE FOR 1-TIME ACTIVATION FEE \$15.00 • END USER HAS CHOICE OF SUBSCRIPTION RATES: MONTHLY \$25.00 / BI-ANNUAL \$125.00 / ANNUAL \$225.00	1 ea	\$1,555 OPT
ALARM SYSTEM DOOR SENSOR	1 ea	\$54 OPT
ALARM SYSTEM KEY FOB REMOTE • UP TO FOUR REMOTES TOTAL	1 ea	\$115 OPT
ALARM SYSTEM MOTION DETECTOR FOR PRO TEC • ONLY ONE MOTION DETECTOR PER TRAILER IS REQUIRED	1 ea	\$379 OPT
STEREO - AM/FM/CD/MP3 • ANTENNA AND SIRIUS UNIVERSAL TUNER INCLUDED • SIRIUS READY AND I-POD READY • 12V BATTERY NOT INCLUDED • BLUETOOTH READY	1 ea	\$1,093 OPT
SPEAKER - CUBE	4 ea	OPT
SPEAKER - EXTERIOR W/ AMP	1 pr	\$607 OPT
ATC CUSTOM OPTIONS		
ATTIC - HEAVY DUTY W/ EXTRUDED ALUMINUM FLOOR - AL • INCLUDES 4" CROSSMEMBERS	15 ft	\$9,690
AWNING - 12V LATERAL ARM WITH ALUMINUM CASE - 16' - BLACK - BLACK/WHITE CHECKERBOARD FABRIC - W/ LED LIGHT STRIP • INCLUDES 12V WALL SWITCH FOR LED LIGHTS	2 ea	\$7,034
AXLES - 8000# - TRIPLE - AIR RIDE - EZ LUBE - ELECTRIC OVER HYDRAULIC DISC BRAKES - 8.5'W - GROUND CLEARANCE 14" - TRUCK AIR SUPPLY SUSPENSION	1 ea	\$20,787
BACK-UP CAMERA SYSTEM - 3 CAMERA - VOYAGER - BLACK • MOUNT ANTENNA EXTENSION HIGH ON ROAD SIDE EXTERIOR WITH SUPPLIED L-BRACKET • INCLUDES POWER WIRE FOR CAMERAS • 7" LCD COLOR MONITOR WITH SPLIT SCREEN • (2) SIDE-MOUNT CAMERAS HARD WIRED, MOUNTED HIGH • (1) WIRELESS CAMERA WITH ANTENNA EXTENSION	1 ea	\$2,389
BATTERY BOX - IN-FLOOR - HOLDS UP TO 3 BATTERIES	1 ea	\$515

CABINET - ALUMINUM - WARDROBE CLOSET - STAND ALONE - 24"W - 24"D - W/ (3) SHELVES AND CLOTHES ROD	1 ea	\$1,233
<ul style="list-style-type: none"> SHELVES EVENLY SPACED 		
DOOR - ESCAPE - 405 SERIES - 48" X 72" - SIDE HINGE	1 ea	\$1,147
DOUBLE AXLE MAINS - 2" X 8" ALUMINUM	34 ft	\$2,210
D-RINGS - SWIVEL - 6000# - RECESSED	8 ea	\$472
FUEL FILLING STATION - GAS - 24 GALLON TANK	1 ea	\$2,281
GAS SHOCK ON ENTRANCE DOOR	1 ea	\$131
GENERATOR/STORAGE/STORAGE - TONGUE MOUNTED - COLOR MATCHED - 52"W X 120"H X 30"D - SLOPED TOP	1 ea	\$4,335
<ul style="list-style-type: none"> GEN COMPARTMENT TO HAVE EXPANDED METAL FLOOR 48" X 24" DOUBLE DOORS FOR STORAGE COMPARTMENT 48" X 36" VENTED DOUBLE GEN DOORS 48" X 36" DOUBLE DOORS FOR STORAGE COMPARTMENT INCLUDES TUBE FRAMED SHELF IN STORAGE COMPARTMENT 		
GRAB HANDLE - ALUMINUM	1 ea	\$31
GRAB HANDLE - STAINLESS STEEL FOLD OUT WITH GRIPS - POWDERCOAT GLOSSY BLACK	1 ea	\$186
HITCH - RECEIVER TUBE - BOLT ON - 2.5"	1 ea	\$610
<ul style="list-style-type: none"> CLASS 3 HITCH MOUNTED TO REAR OF TRAILER 		
LADDER - INTERIOR - W/ HEAVY DUTY HATCH TO ATTIC	1 ea	\$1,456
<ul style="list-style-type: none"> LADDER WITH KNURLED RUNGS 32" X 32" .25" ATP LIFT OFF HATCH COVER HATCH SECURED WITH JEEP STRAPS 		
LADDER - INTERIOR - W/ PREMIUM 30" X 30" MF ALUMINUM HATCH TO ROOF (STACKER)	1 ea	\$1,718
LIFT - SPLIT RAIL - 16' - AL 6000# CAPACITY - INTERIOR 96"W - 11'-11.33'H - 77" DECK WIDTH - WITH NO HINGED TRANSITION RAMP	1 ea	\$14,744
<ul style="list-style-type: none"> SPLIT RAIL DESIGN 6000# CAPACITY 4 1/2" THICK TILT CAPABILITY EXTRUDED ALUMINUM FLOORING (4) 6000# D-RINGS RECESSED AIRLINE TRACK MILL FINISH AL UNDER SIDE STANDARD UNDER LIFT STRIP LIGHTING W/ 3-WAY SWITCH 2 WALL REMOTE LOCATIONS DOES NOT INCLUDE: OPTIONAL LIFT INSERTS INCLUDES 2" X 2" X 0.25" C-CH WELDED TO LIFT PLATFORM FOR REMOVEABLE RAMPS 		
PREP - FOR FUTURE WRAP	1 ea	
<ul style="list-style-type: none"> PAINTABLE CAULK REQUIRED-OPTIONED SEPARATELY VIN STICKER ON TRAILER TONGUE SHIP ALL LOGOS, STICKERS & EMBLEMS LOOSE INSIDE TRAILER 		
RAMP - REMOVABLE - ALUMINUM - 18"W X 31"L - EXTEND FROM STACKER LIFT TO RAMP DOOR	1 pr	\$901
RAMP EXTENSION - ALUMINUM - 40"W X 72"L	1 pr	\$1,859
RAMP EXTENSION HARDWARE - BUMPER - ADJUSTABLE - SET OF 4	1 set	\$182
ROOF - WALK ON - .125 ATP - AL - FULL WIDTH	34 ft	\$7,956
<ul style="list-style-type: none"> INSTALLED OVER ALUMINUM ROOF 		
SPARE TIRE/WHEEL - 215/75R17.5/LRH - RADIAL ON GREY MOD - GOODYEAR	1 ea	\$1,080
TIRE RACK - FOLD UP - 7'	1 ea	\$837
TRIM - SPOILER - REAR - COLOR MATCHED W/ 3 LED LIGHTS	1 ea	\$759
TRIM - VERTICALS - REAR - COLOR MATCHED	1 ea	
TRUCK PLUG - 7 WAY - BUMPER PULL - FOR ADDITIONAL TRAILER	1 ea	\$626
<ul style="list-style-type: none"> REQUIRES SIGNED DEVIATION FROM FOR DECREASED VOLTAGE REQUIRES (2) SEPARATE BRAKE CONTROLLERS IN TOW VEHICLE BYPASSES ALL SYSTEMS IN TRAILER (JUST A JUMPER FROM TOW VEHICLE TO SECOND TRAILER) 		

WHEEL BOX - 36"W X 12"H X 8.5"D - SMOOTH ALUMINUM	1 pr	\$90
WHEEL BOX - 80"W X 12"H X 8.5"D - SMOOTH ALUMINUM	1 pr	\$112
WINCH ROLLER - FOR STACKER LIFT	1 ea	\$117

TOTALS

Subtotal \$200,187.00

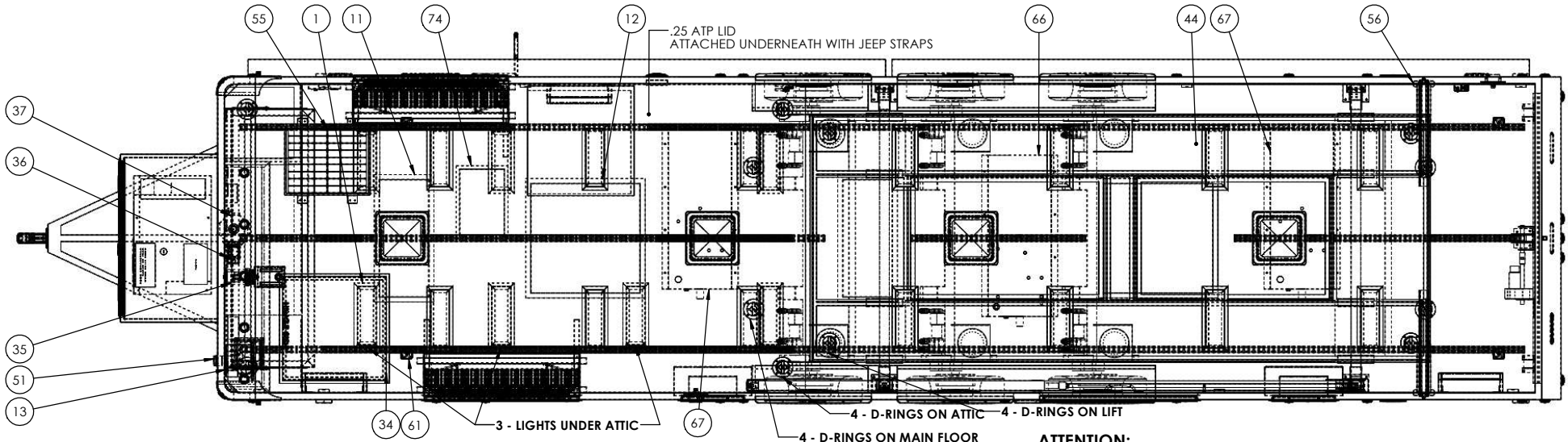

**ALL EXTERIOR DOORS
KEYED ALIKE**

**ATTENTION:
ATC IS NOT RESPONSIBLE FOR CLEARANCE OF VEHICLE
UNTIL CUSTOMER/DEALER COMPLETES VEHICLE CLEARANCE
FORM AND IS VERIFIED BY ATC ENGINEERING DEPARTMENT.**

**DIMENSIONS ARE NOMINAL. STRUCTURAL MEMBERS OFTEN DICTATE
WHERE INTERIOR FEATURES CAN BE PLACED. CONSEQUENTLY, SOME
DIMENSIONED ITEMS RETAIN A +/- 2" TOLERANCE. CRITICAL (BUBBLED)
DIMENSIONS WILL RETAIN A TOLERANCE OF +/- 1/4".**

BOM TABLE				
ITEM NO	PART NO	FILE NAME	DESCRIPTION	QTY
1		18" LED RECESSED 12V	18" RECESSED	21
7		ALARM BRAIN, PROTEC		1
8		AWNING LATERAL ARM	16'	2
9		AXLE - STI-21.6076	HF93 8000#	3
10		BOGEY WHEEL	BOGEY WHEEL	2
11		BOX, IN FLOOR	3 BATTERIES	2
12		BOX, IN FLOOR	Spare Tire	2
13	48260	BREAKER BOX	50 AMP WITH CONVERTER	1
18		CAMERA, BACKUP		2
19		CAMERA, BACKUP		1
20		CONTROL STATION - LIFT	AFT	1
21		CONTROL STATION - LIFT	FORE	1
22		COUPLER, 25K BULLDOG	25,000 CAPACITY 5/16 BULLDOG COUPLER	1
23		D-RING - RECESSED	6,000#	12
25		DOOR, FUEL FILL		1
30		GEN START, FUEL GAUGE		1
31		GENERATOR	8.0 KW ONAN DIESEL	1
32		GRAB HANDLE-FOLDING		1
33	13371	HANDLE, RAMP DOOR	HANDLE - RAMP DOOR	2
34		HATCH, ROOF	30 x 30	1
35		HYDRAULIC POWER UNIT - 12V - LIFT	12V - 2500 PSI	1
36		HYDRAULIC POWER UNIT - 12V - SINGLE POST JACK		1
37		JACK, HYDRAULIC - SINGLE POST		1
38		LADDER, STRAIGHT		1
39		LADDER, STRAIGHT - STK-216076	LADDER (FIXED), AL - 72"	1
40		LADDER, STRAIGHT-216076		1
42	113630	LID, ATTIC - STK	PANEL - ATTIC HATCH	1
43		LIFT_STRAP	SINGLE PULLY W/3 1/2" SHAFT	1
44		LIFT, VEHICLE - 6000#-216076	16FT	1

BOM TABLE				
ITEM NO	PART NO	FILE NAME	DESCRIPTION	QTY
45		LIGHT, LED CLEARANCE	AMBER LENS	20
46		LIGHT, LED CLEARANCE	RED LENS	9
47		LIGHT, LED DOCKING		2
48		LIGHT, LED SCENE	12V; 7" x 3"	4
49		LIGHT, PORCH		1
50		LIGHT, PUCK	LED	5
51		MOTORBASE	50 AMP	1
52		OUTLET, ELECTRICAL	120V 15A EXTERIOR	4
53	11978	OUTLET, ELECTRICAL	120V 15A INTERIOR	8
54		OUTLET, ELECTRICAL	120V 15A INTERIOR-USB	2
55		PANEL, SOLAR	50 WATT	1
56		POD JACK, STACKER	30"	2
57		RECEIVER, 2IN - BOLT ON		1
58		ROOF VENT	FANTASTIC FAN	4
59		SOLAR CONTROLLER, PANEL		1
60		SPEAKER, 6.5IN	EXTERIOR	2
61		SPEAKER, CUBE		4
63		STEP ASSY, AL - SLIDE IN-OUT		2
64		STEREO		1
65		SWITCH STRAP LIFT		1
66		TANK, FUEL	28 GAL END FILL(ST24-1)D	1
67		TANK, FUEL	28 GAL END FILL(ST24-1)G	2
68		TIRE RACK FOLDING-216076	6' TIRE RACK	1
69		TIRES	215/75/17.5	6
70		TRANSFER SWITCH	50 AMP	1
71		VENT, SALEM		2
72		WHEEL WELL - AL-216076	8.5 x 12.0 x 36.0	2
73		WHEEL WELL - AL-216076	8.5 x 12.0 x 80.0	2
74		WINCH BOX		1

REVISION TABLE

REV.	DESCRIPTION	DATE	DONE BY
A	GO TO MEETING CHANGES; ADDED TIRE RACK; ADDED AIRLINE TRACK; ADDED SCENE LIGHT; ADDED AWNING; CHANGED FUEL FILL; ADDED BOX IN FLOOR; EDITED LIFT; ADDED RECIVER TO REAR; ADDED PUCK LIGHTS; ADDED CIELING LIGHTS; ADDED DIMENSIONS AND NOTES; MOVED LADDER; ADDED SECOND LADDER; CHANGED WHEEL WELLS; ADDED RECEPITS; CHANGED GEN; ADDED STEP AND DOOR; INCREASED SIZE OF ESCAPE DOOR;	8/28/2018	HTY
B	EDITED TONGUE BOX; REMOVED ONE TIRE BOX AND ADDED FUEL FILL STATION; CHANGED FROM HATCH TO ATTIC TO COVER	9/4/2018	HTY
C	2ND GO TO MEETING; REMOVED A/C; SHRANK GEN; ADJUSTED COMPARTMENTS AND CABINETS; LOWERED ATTIC; MOVED LADDED; CHANGED TO INTELLIPOWER BB; ADDED DIMS AND NOTES	9/6/2018	HTY
D	FINAL QC CHANGES; ADDED DIMS; CLEANED UP DRAWINGS	9/18/2018	HTY
E	CHANGED WALL THICKNESS; CHANGED WHEEL WELLS	9/19/2018	HTY
F	ADDED DIMS AND ADDITIONAL PAGE; ADDED NOTES FOR LOCATIONS	9/20/2018	HTY
G	ADDED SHELF TO TOP STORAGE; ADDED GRAB HANDLES TO INTERIOR	9/25/2018	HTY
H	MOVED D RINGS; CHANGED LADDER	10/2/2018	HTY

**ALL LOCATIONS ARE NOMINAL UNLESS CRITICAL
DIMENSIONS ARE SPECIFICALLY NOTED**

PROPRIETARY AND CONFIDENTIAL:
THE INFORMATION CONTAINED IN THIS DRAWING IS THE SOLE
PROPERTY OF THE ALUMINUM TRAILER COMPANY. ANY
REPRODUCTION IN PART OR AS A WHOLE WITHOUT THE WRITTEN
PERMISSION OF THE ALUMINUM TRAILER COMPANY IS PROHIBITED.



TITLE:
8.5 X 34 ALUMINUM STACKER

DRAWN BY:	DATE:	VIN/PART #	REV.
HTY	8/22/18	216076	H
FILE NAME: QSTAB 85x34-ADVANTAGE-RONS HAULER-216076			
SCALE:1:24	DATE PRINTED: 10/2/2018	SHEET 1 OF 7	

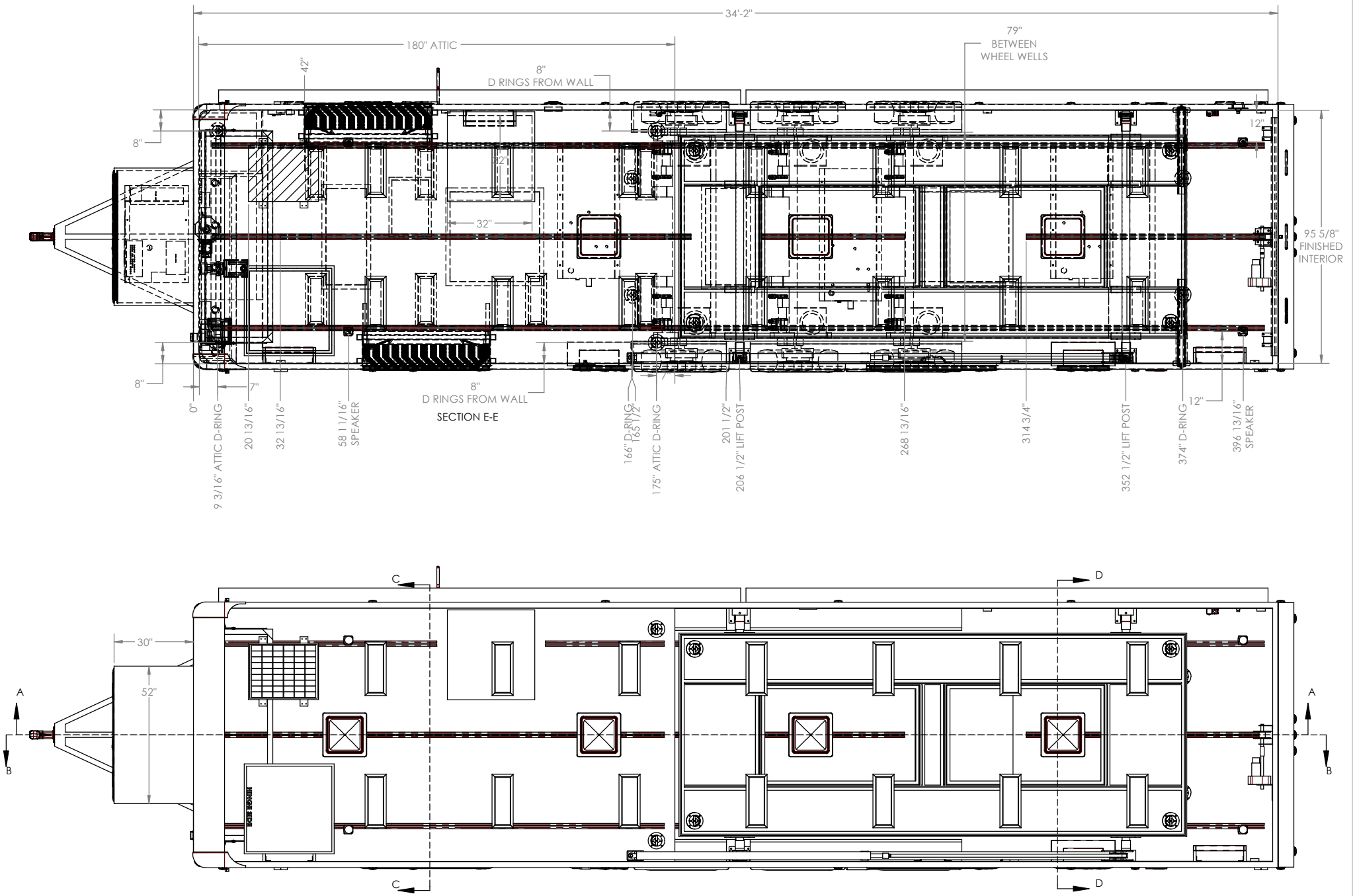

TITLE: 8.5 X 34 ALUMINUM STACKER			
DRAWN BY: HTY	DATE: 8/22/18	VIN/PART # 216076	REV. H
FILE NAME: QSTAB 85x34-ADVANTAGE-RONS HAULER-216076			
SCALE: 1:24	DATE PRINTED: 10/2/2018	SHEET 2 OF 7	

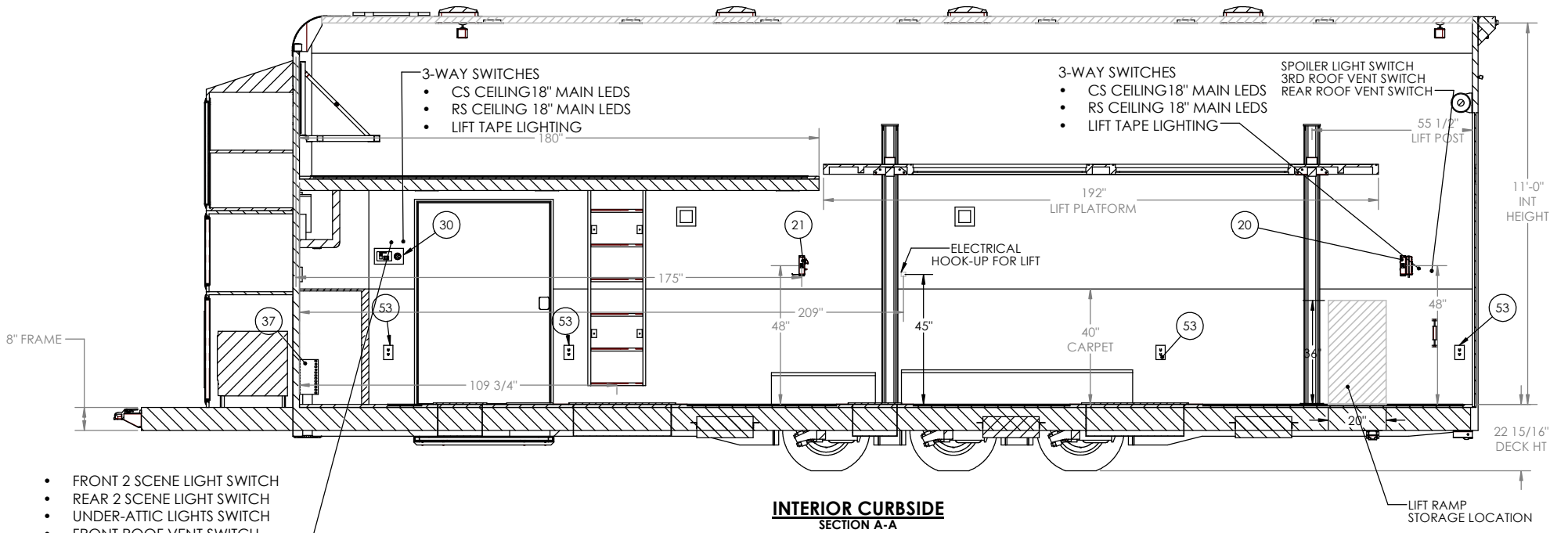

- FRONT 2 SCENE LIGHT SWITCH
- REAR 2 SCENE LIGHT SWITCH
- UNDER-ATTIC LIGHTS SWITCH
- FRONT ROOF VENT SWITCH
- 2ND ROOF VENT SWITCH
- PORCH LIGHT
- AWNING CONTROLS

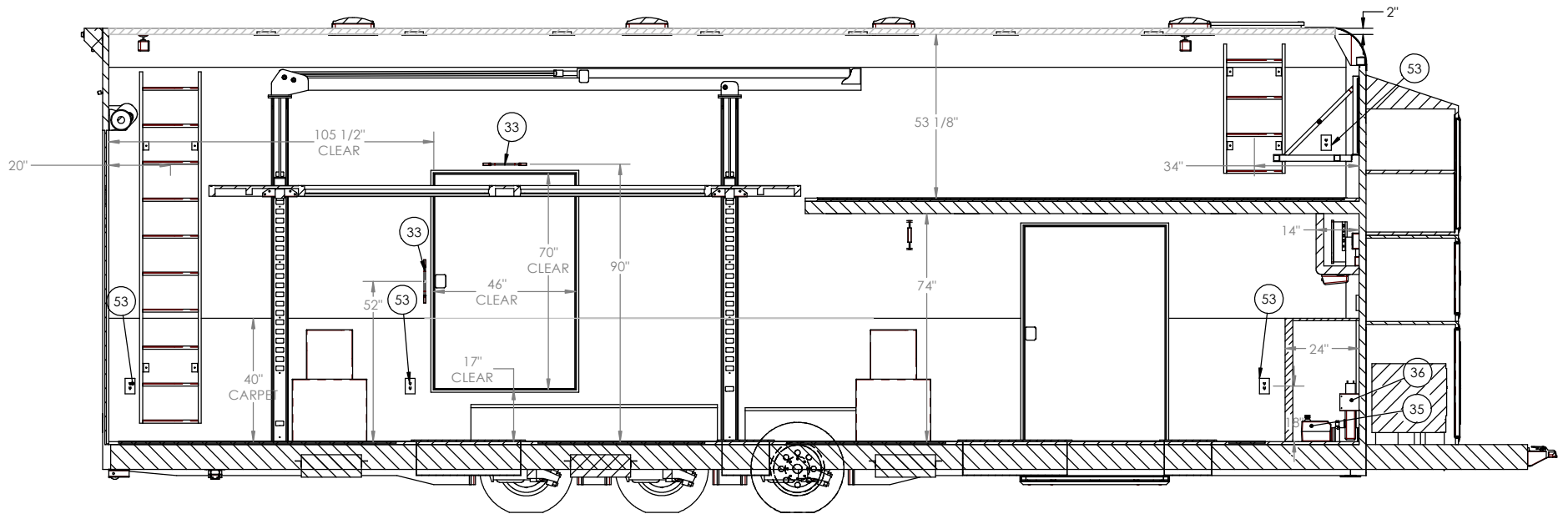

ATC
WORLD CLASS TRAILERS

TITLE: 8.5 X 34 ALUMINUM STACKER

DRAWN BY: HTY	DATE: 8/22/18	VIN/PART # 216076 H	REV.
FILE NAME: QSTAB 85x34-ADVANTAGE-RONS HAULER-216076	SCALE: 1:26	DATE PRINTED: 10/2/2018	SHEET 3 OF 7

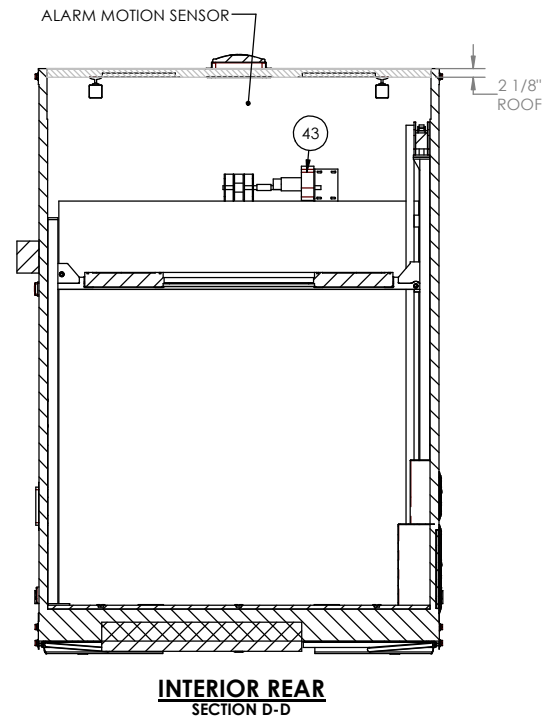
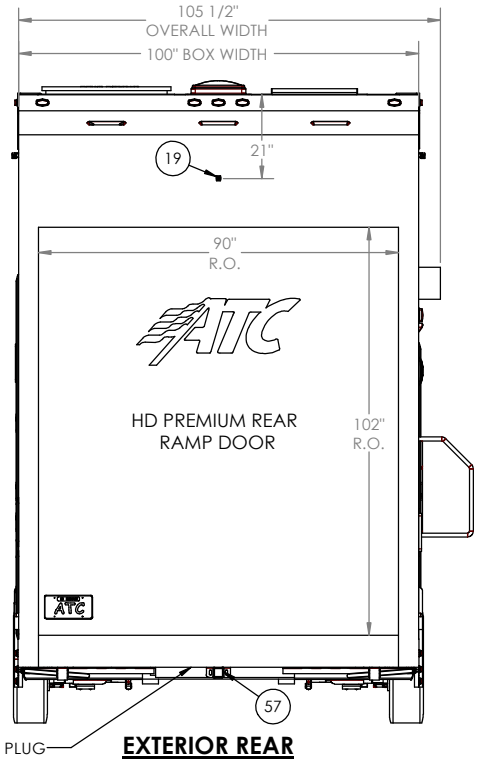
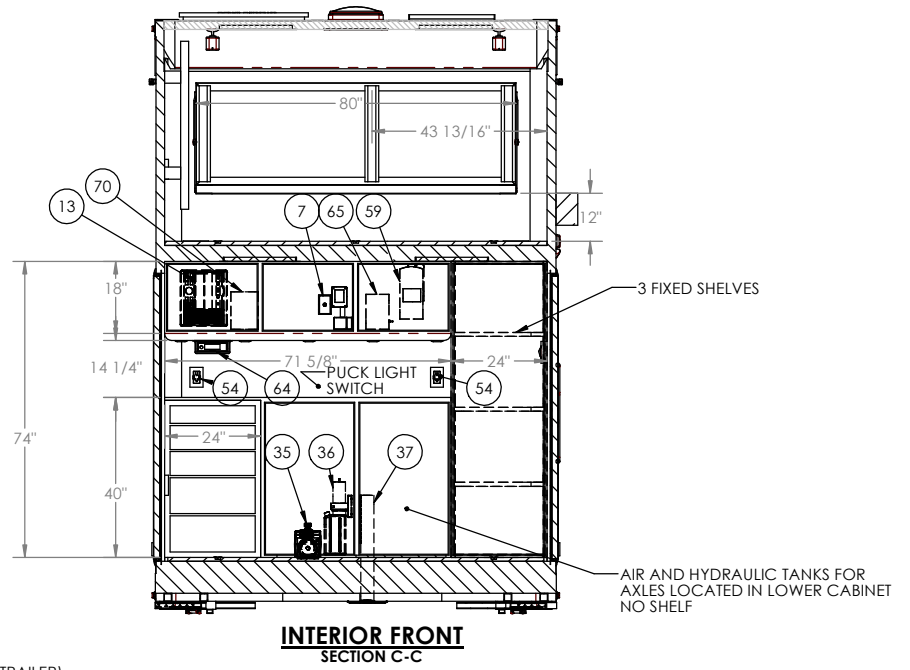
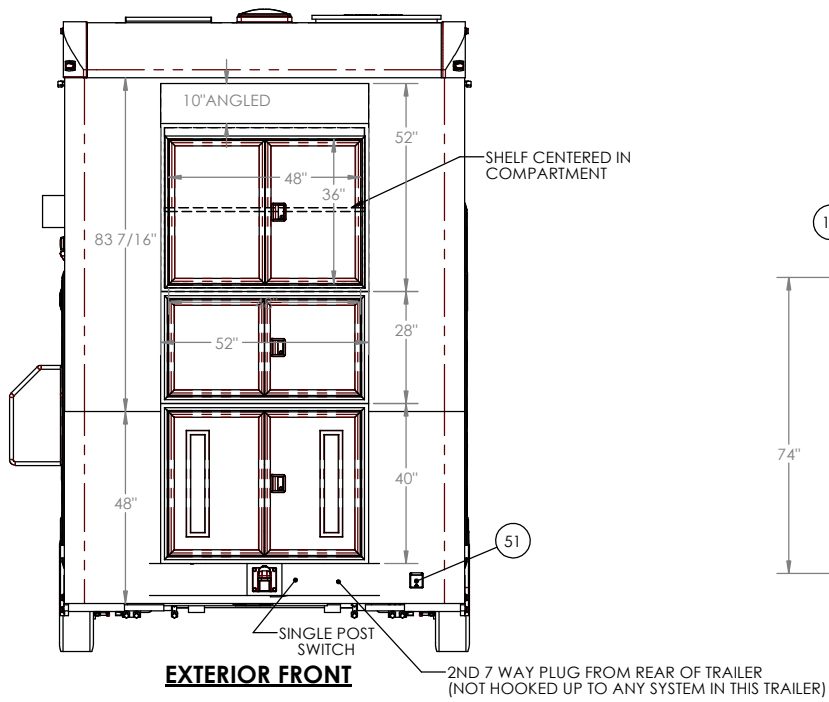

ATC
WORLD CLASS TRAILERS

TITLE: 8.5 X 34 ALUMINUM STACKER

DRAWN BY: HTY	DATE: 8/22/18	VIN/PART # 216076 H	REV.
FILE NAME: QSTAB 85x34-ADVANTAGE-RONS HAULER-216076	SCALE: 1:24	DATE PRINTED: 10/2/2018	SHEET 4 OF 7

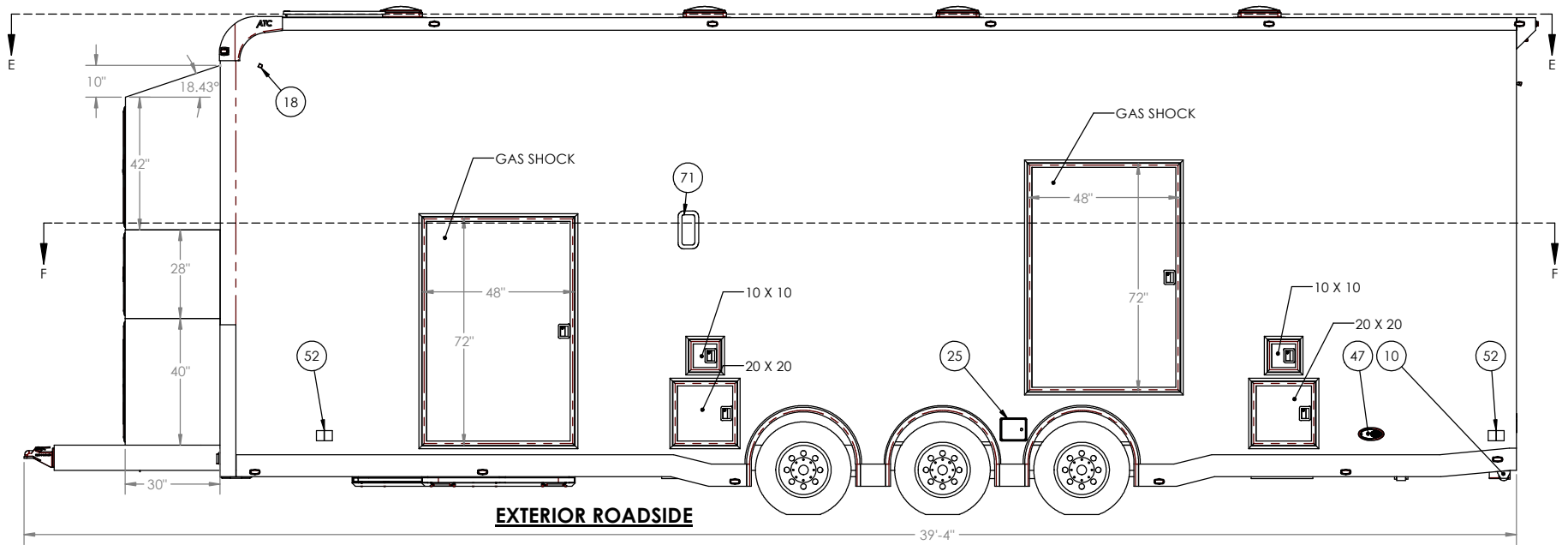

ATTENTION:
 ATC IS NOT RESPONSIBLE FOR HIGHER
 THAN DESIRED TONGUE WEIGHTS OF
 TRAILERS DUE TO OPTIONS ON OR NEAR
 FRONT OF TRAILER.

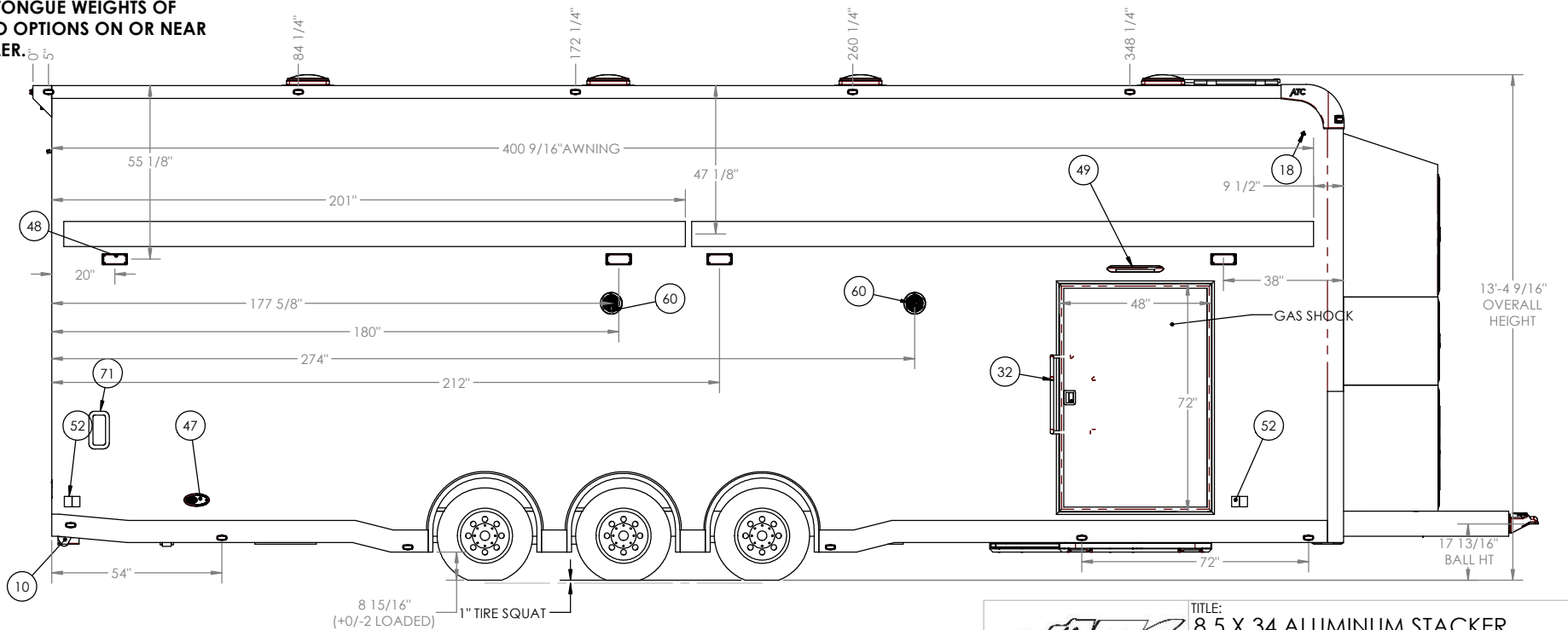

TITLE: 8.5 X 34 ALUMINUM STACKER			
DRAWN BY: HTY	DATE: 8/22/18	VIN/PART #	REV.
		216076 H	
FILE NAME: QSTAB 85x34-ADVANTAGE-RONS HAULER-216076			
SCALE: 1:26	DATE PRINTED: 10/2/2018	SHEET 5 OF 7	

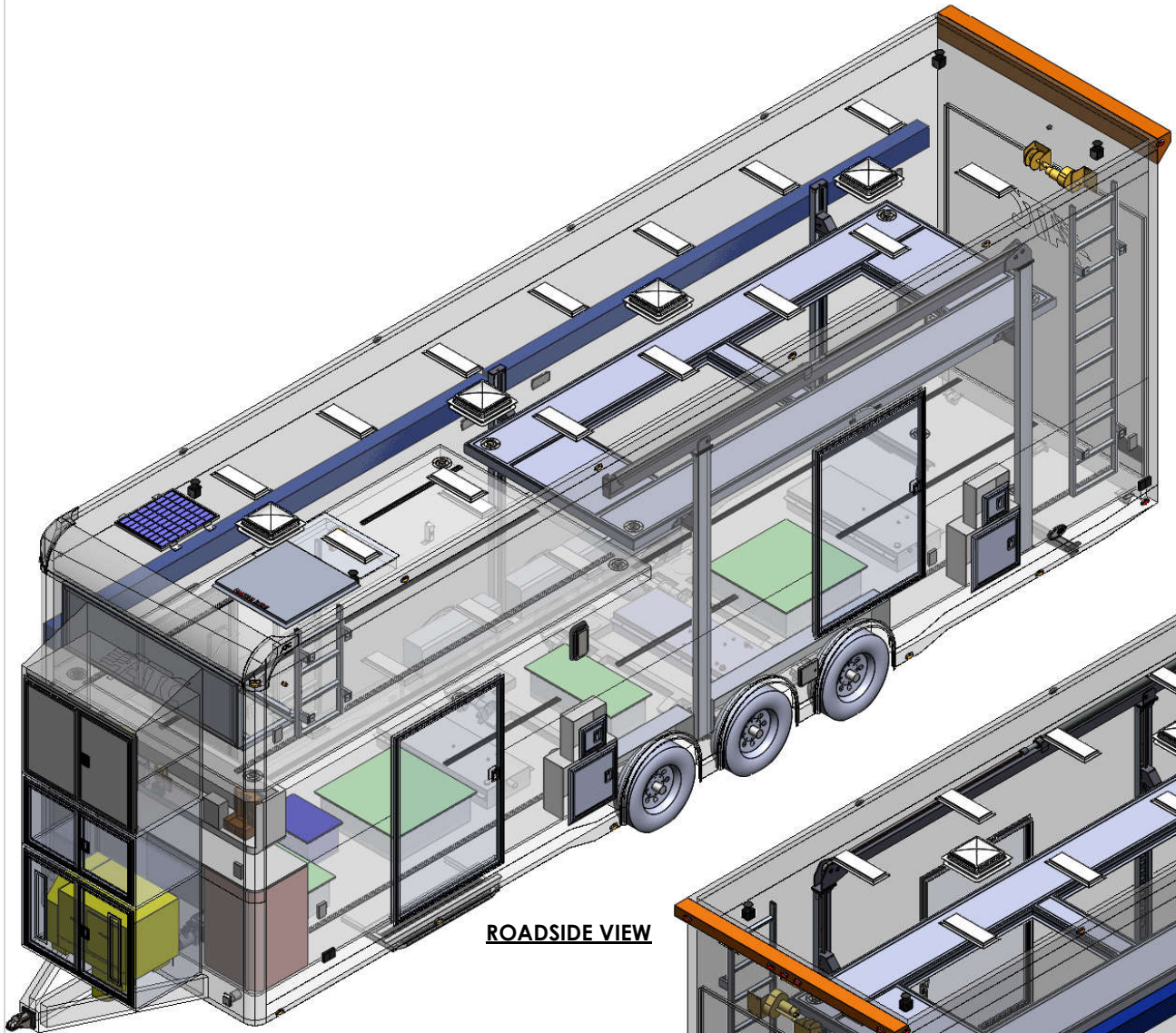

ROADSIDE VIEW

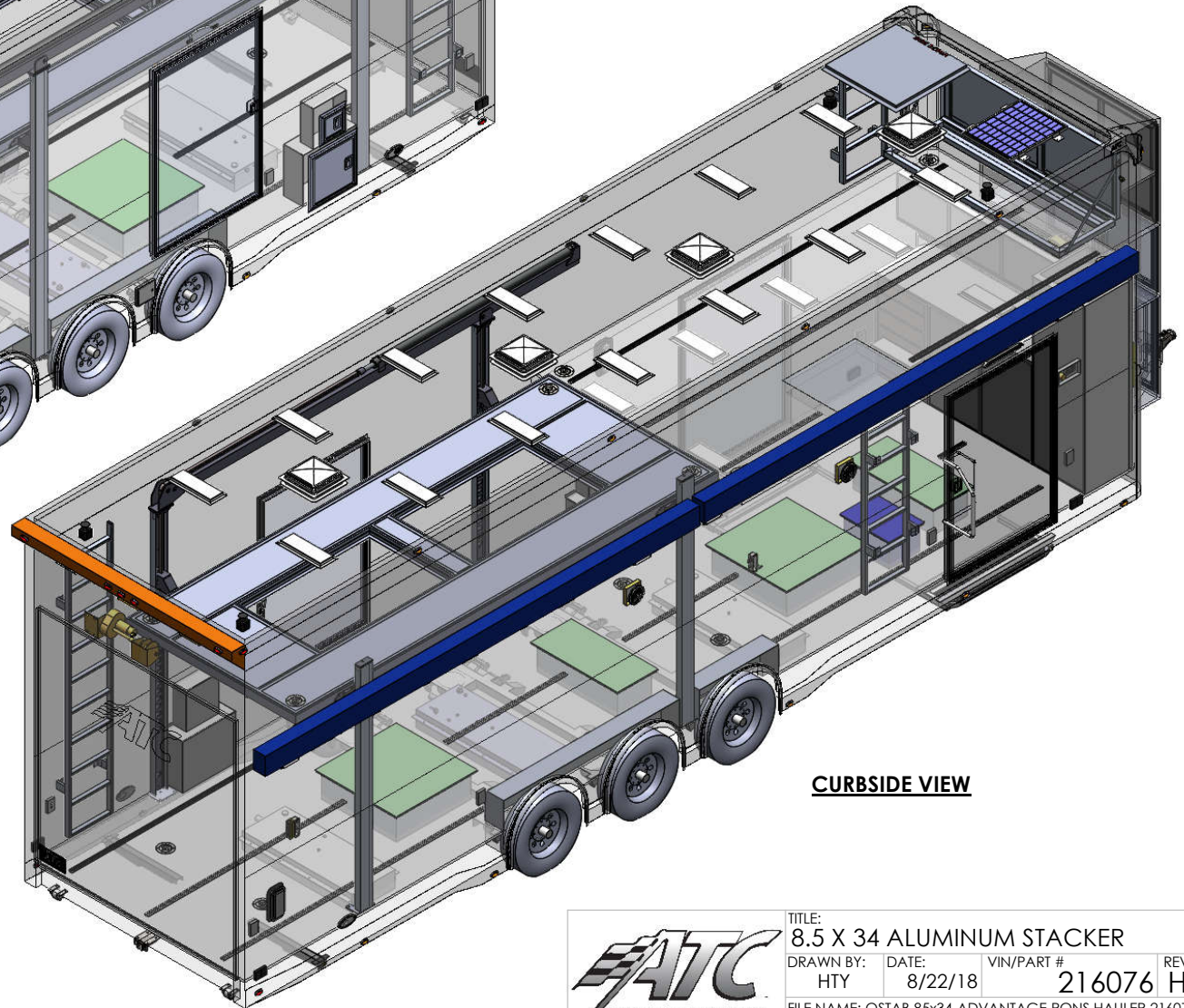

CURBSIDE VIEW

	TITLE: 8.5 X 34 ALUMINUM STACKER			REV.
	DRAWN BY: HTY	DATE: 8/22/18	VIN/PART # 216076 H	
FILE NAME: QSTAB 85x34-ADVANTAGE-RONS HAULER-216076				
SCALE: 1:28	DATE PRINTED: 10/2/2018	SHEET 6 OF 7		

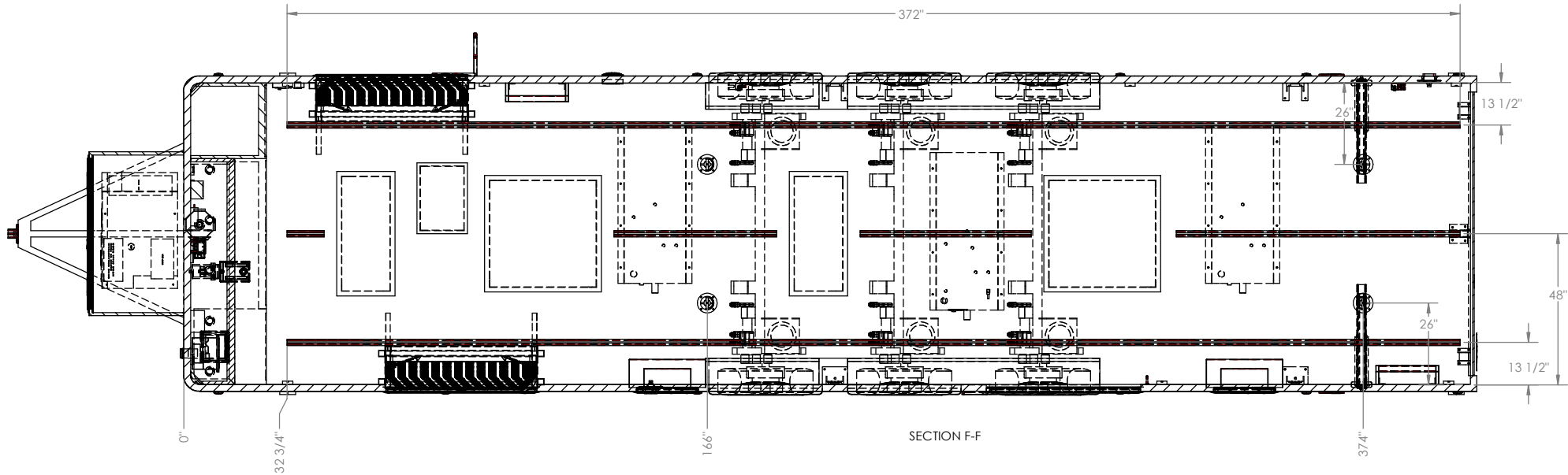

MAIN FLOOR LAYOUT



TITLE: QSTAB 85x30 3T7.0 ST305 PED			
DRAWN BY: HTY	DATE: 8/22/18	VIN/PART # 216076 H	REV.
FILE NAME: QSTAB 85x34-ADVANTAGE-RONS HAULER-216076			
SCALE: 1:24	DATE PRINTED: 10/2/2018	SHEET 7 OF 7	















