



Renegade Motorhomes

Kibbi, LLC, 52216 SR 15, Bristol, Indiana 46507 USA

Tel. 574-848-1126 Fax 574-848-1127

www.renegaderv.com

Job #: K01-2792 REV:

VIN #:

Production Order

Dealer: Westside Motorcoach

Salesman: Harley Miller

Phone: (815) 923-0100 Ext. 0000

Fax: (815) 923-0101 Ext. 0000

Customer Name:

Date Written: 3/22/2017

Date Processed:

| Description | Color | UOM | Qty | Price |
|--|-------|-----|-----|-------|
| Chassis | | | | |
| Customer Supplied Chassis | | EA | | |
| Volvo 500HP | | | | |
| Wheel Alignment | | EA | | |
| US Domiciled | | EA | | |
| Renegade Conversion | | | | |
| 2018 3400 AM Motorhome | | EA | | |
| 245" C/A | | | | |
| Exterior | | | | |
| Larger Bunk Area | | EA | | |
| 66 x 95 | | | | |
| Electric Trailer Brake Controller w/ Digital Display | | EA | | |
| Stainless Steel on Bunk Exterior | | EA | | |
| Undercoating | | EA | | |
| 4-Point Auto Leveling System (Std. 26' or Longer) | | EA | | |
| Power Locking Baggage Doors - where applicable | | EA | | |
| Trimark Handle Keyless Entry - Side Door | | EA | | |
| Side Swing Baggage Doors w/strut assist - Bright Stainless | | EA | | |
| Full 7'6" Interior Height (90") | | EA | | |
| Renegade Universal Adjustable Hitch | | EA | | |
| 30,000 Lb. 2 5/16" Ball Hitch Insert (Std. Tandem Axle) | | EA | | |
| ---Full width mudflap | | | | |
| ---12v/110v recepts in (2) storage boxes passenger side - 15A Load | | | 2 | |
| Warranty | | | | |
| One Year Limited Conversion Warranty (Included) | | EA | | |
| Slideouts | | | | |
| 6' Slideout Room | | EA | | |
| 12' Slideout Room | | EA | | |



Renegade Motorhomes

Kibbi, LLC, 52216 SR 15, Bristol, Indiana 46507 USA
 Tel. 574-848-1126 Fax 574-848-1127
 www.renegaderv.com

Production Order

Dealer: Westside Motorcoach
 Salesman: Harley Miller
 Phone: (815) 923-0100 Ext. 0000
 Fax: (815) 923-0101 Ext. 0000

Job #: K01-2792 REV:
 VIN #:

Customer Name:
 Date Written: 3/22/2017
 Date Processed:

| Description | Color | UOM | Qty | Price |
|---|---------------|-----|-----|-------|
| Bed Slideout | | EA | | |
| Windows on sides of Bed Slideout | | EA | | |
| ---C/S Wardrobe Slideout | | | | |
| Awnings | | | | |
| Slide Toppers | | EA | | |
| ---Full length Zip Dee Awning w/ Lighted Lead Rail | Black/Black | | | |
| 32' 4" | | | | |
| Windows | | | | |
| Bonded Thermopane Windows | | EA | | |
| Skylight over Shower | | EA | | |
| (2) Bunk Windows w/ Valances & Shades | | EA | | |
| United Manual Day/Manual Night Window Shades | | EA | | |
| Interiors | | | | |
| Cab / Conversion Divider Privacy Shade | | EA | | |
| Cab / Conversion Divider (Wood Doors) | | EA | | |
| Standard Hardware & Fixture Finish- Brushed Nickel | Nickel | EA | | |
| "Soft Touch" Padded Vinyl Ceiling (White) | White | EA | | |
| Decor Package | Waterfall | EA | | |
| Bedding | Waterfall | EA | | |
| Can Drawers | | EA | 2 | |
| Pantry | | | | |
| Large Item Drawers | | EA | 2 | |
| Pantry | | | | |
| Wood Valances - 2015 Classic Style w/no decor tops | | EA | | |
| ---Padded walls w/ beadboard wainscoting | Ander Natural | | 34 | |
| ---Outlets with usb one in the bunk one in the dinette area | | | 2 | |
| ---Bead Board wainscoting | | | | |



Renegade Motorhomes

Kibbi, LLC, 52216 SR 15, Bristol, Indiana 46507 USA
 Tel. 574-848-1126 Fax 574-848-1127
 www.renegaderv.com

Production Order

Dealer: Westside Motorcoach
 Salesman: Harley Miller
 Phone: (815) 923-0100 Ext. 0000
 Fax: (815) 923-0101 Ext. 0000

Job #: K01-2792 REV:
 VIN #:

Customer Name:
 Date Written: 3/22/2017
 Date Processed:

| Description | Color | UOM | Qty | Price |
|---|----------------------|-----|-----|-------|
| Furniture | | | | |
| Captain's Chairs | UL Woodpecker | EA | | |
| Bunk Mat | Tan | EA | | |
| Flexsteel Hide-a-bed Sofa /Dinette Ensemble | UL Woodpecker | EA | | |
| Flexsteel Hide-a-Bed Sofa IPO Easy Bed | UL Woodpecker | EA | | |
| Small King Bed 66 x 80 Ortho Rest Mattress | | EA | | |
| All Ultra Leather Package - (2) Std. Sofas | UL Woodpecker | EA | | |
| Cabinets | | | | |
| Cabinet color Upgrade | Italian Nutmeg | EA | | |
| Maple Cabinets | Italian Nutmeg | EA | | |
| Lexington Doors | | | | |
| ---Dove Tailed Drawers | | | | |
| Flooring | | | | |
| Honed Finish Porcelain Tile - per foot(Includes Stepwell) | Oly Must Ivory 12x24 | EA | 34 | |
| Tile - Floor Grout | Bone | EA | | |
| Carpet | Flaxseed | EA | | |
| Carpeted Floor Mats in Cab | Flaxseed | EA | | |
| Countertops | | | | |
| Tile Backsplash in Kitchen | Copper Chocolate | EA | | |
| Tile - Backsplash Grout | Chestnut | EA | | |
| Solid Surface Countertops | Parma | EA | | |
| Appliances | | | | |
| 2 Burner Induction Cook Top | | EA | | |
| Weber 110V Electric Grille on Slide Tray | | EA | | |
| Central Vacuum System - Basement Mount | | EA | | |
| Samsung Convection Microwave | SS | EA | | |



Renegade Motorhomes

Kibbi, LLC, 52216 SR 15, Bristol, Indiana 46507 USA

Tel. 574-848-1126 Fax 574-848-1127

www.renegaderv.com

Job #: K01-2792 REV:

VIN #:

Production Order

Dealer: Westside Motorcoach

Salesman: Harley Miller

Phone: (815) 923-0100 Ext. 0000

Fax: (815) 923-0101 Ext. 0000

Customer Name:

Date Written: 3/22/2017

Date Processed:

| Description | Color | UOM | Qty | Price |
|--|----------------|-----|-----|-------|
| ---13 cu ft Elite 4 door refer w/no icemaker | SS | | | |
| Water Systems | | | | |
| Toilet- Macerator, Bone Color (Electric Flush) | | EA | 2 | |
| 150 Gallon Fresh Water Tank | | EA | | |
| 1 pc Fiberglass Shower | Adobe | EA | | |
| Single Lever Kitchen Faucet w/ Retractable Sprayer | Brushed Nickel | EA | | |
| Waste Tank Flush | | EA | | |
| Outside Spigot (by holding tanks) | | EA | | |
| Single Bowl Stainless Steel Kitchen Sink w/ Cover | | EA | | |
| (3) 75 Gallon Holding Tanks, (2) Gray, (1) Waste | | EA | | |
| Water Management Bay | | EA | | |
| (2) Holding Tank Heat Strips per Tank | | EA | | |
| Stainless Undermount Bath Sink | | EA | 2 | |
| ---Extra 100 gal fresh water tank with pump in a outside storage box | | | | |
| ---Truma tankless water heater | | | | |
| ---Add Half Bath to Single Bath Floorplan | | | | |
| Mechanical Systems | | | | |
| Gen-Turi Exhaust | | EA | | |
| A/C (3) 15,000 BTU Low Profile Ducted Roof Mount | | EA | | |
| Magnum 2800 Watt Inverter w/AGS | | EA | | |
| Power Vent (2) Remote Control - One Remote | | EA | | |
| Power Vent(1) Additional Remote Control | | EA | | |
| Power Retractable Shore Cord Reel w/36' Cord | | EA | | |
| Propane 38 Gal. Remote LP Tank Between Frame Rails | | EA | | |
| Generator 12.5 KW Onan Quiet Diesel | | EA | | |
| Fill with Propane | | EA | | |
| (1) 95A Deep Cycle House Battery | | EA | 2 | |
| (4) Total in coach | | | | |
| (2) 95A Deep Cycle House Batteries | | EA | | |
| 35,000 Btu SFQ Series Propane Furnace | | EA | | |



Renegade Motorhomes

Kibbi, LLC, 52216 SR 15, Bristol, Indiana 46507 USA

Tel. 574-848-1126 Fax 574-848-1127

www.renegaderv.com

Job #: K01-2792 REV:

VIN #:

Production Order

Dealer: Westside Motorcoach

Salesman: Harley Miller

Phone: (815) 923-0100 Ext. 0000

Fax: (815) 923-0101 Ext. 0000

Customer Name:

Date Written: 3/22/2017

Date Processed:

| Description | Color | UOM | Qty | Price |
|---|-------|-----|-----|-------|
| Electronics | | | | |
| Onkyo Home Theater System | | EA | | |
| Samsung Blu-ray Player in Living Area | | EA | | |
| Samsung Blu-ray Player in Bedroom | | EA | | |
| Satellite Dish Receivers - Specify DirecTV or Dish | | EA | 2 | |
| Direct TV | | | | |
| (5) MITO In-Ceiling Home Theater Speakers | | EA | | |
| Universal Remote Control | | EA | | |
| 360 Degree UHF/VHF TV Antenna w/Power Amp | | EA | | |
| Back-up Monitor & Camera (truck only) w/ Trailer Plug | | EA | | |
| Outside Entertainment Center: 32" Smart LED TV, AM/FM/CD/DVD & Speakers | | EA | | |
| Winegard Mission RT4035T In-Motion Satellite Dish- Receivers not Included | | EA | | |
| Hide-Away Sub | | EA | | |
| Manual TV Slide (Bunk) | | EA | | |
| ---43" LED smart tv ILOS - LQ | | | | |
| w/Swing Arm | | | | |
| ---XM Satellite radio Ant. | | | | |
| ---43" LED smart tv ILOS - Bedroom | | | | |

Order Notes:

NOTE: Due to continued improvement & changes in suppliers, design & production: equipment, colors, material specifications, prices & model availability are subject to change without notice. Changes made to confirmed orders are subject to a change order fee of up to \$1500.

Rev: 04/2/2012

Please Sign Here To Confirm Order:

Chassis: _____
 Base: _____
 Options: _____
 Paint: _____
 Freight: _____
 Discount: _____

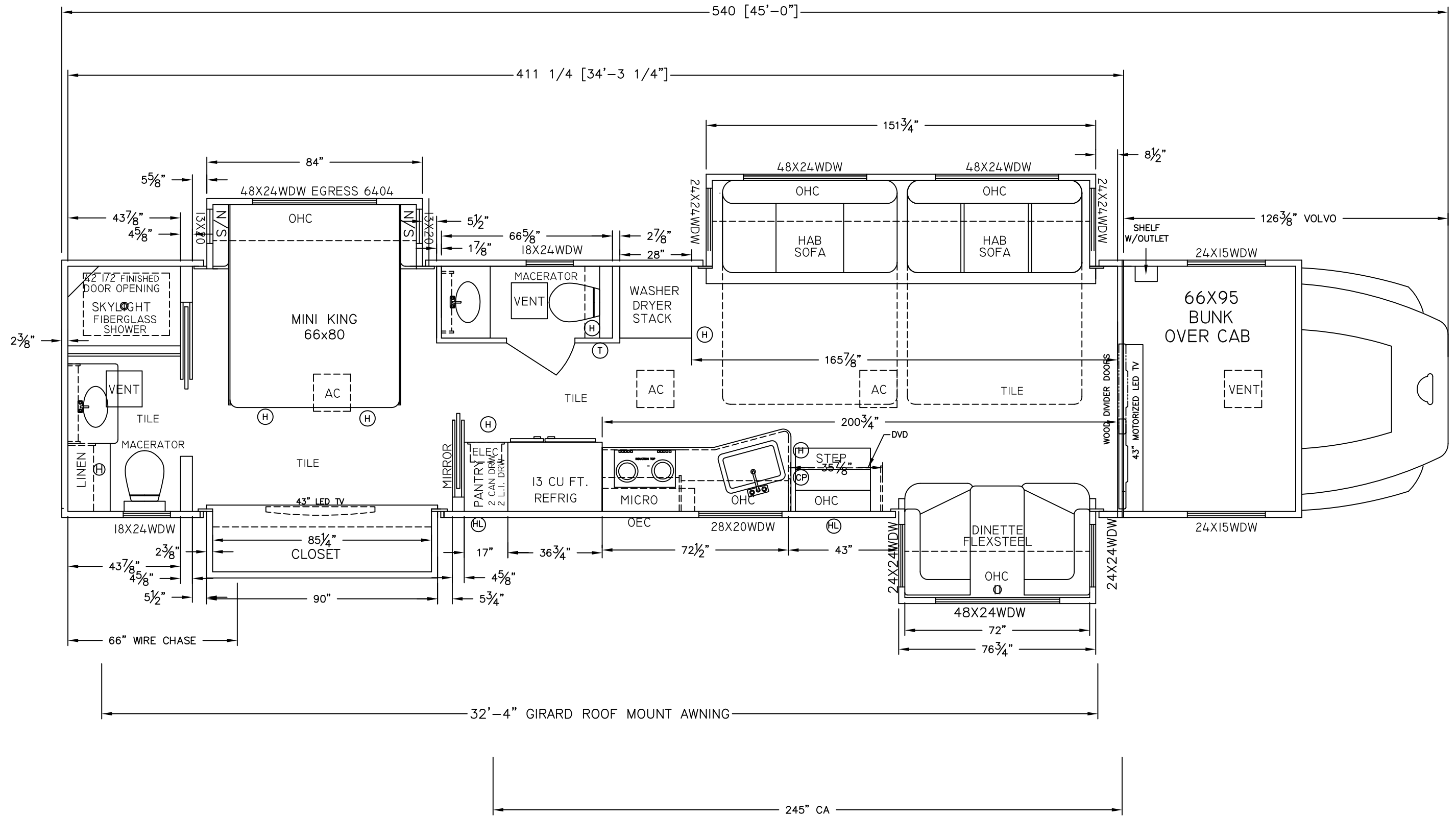

This drawing and its contents are the property of Renegade / Kibbi LLC and are not to be copied or reprinted without written consent



| | | | |
|--------------------------------|------------------------------|---|------------------------------|
| DRAWN BY: LES | MODEL: K01-2792 | DRAWING DESCRIPTION: FLOOR PLAN | CUSTOMER: WESTSIDE |
| DRAWN DATE: 04/18/17 | DRAWING SCALE: NTS | SERIES: CORE | FILE LOC & FILE NUMBER: |

| LET. | REVISION DESCRIPTION | BY | DATE |
|------|----------------------|----|------|
| | | | |
| | | | |
| | | | |
| | | | |